



VERISURF 2017

NEW RELEASE HIGHLIGHTS

“Verisurf 2017 reflects our ongoing commitment to open standards and interoperability - to enable more seamless workflows and give manufacturers improved ability to maintain a digital thread between design, manufacturing, and quality inspection.”

Ernie Husted, President of Verisurf Software, Inc.

FEATURES AND BENEFITS

- UX makeover enhances productivity
- SDK opens Verisurf to user apps
- Power Surface advances surfacing
- New Scan settings for better results
- AutoAlign easier and more flexible
- Improved R.E. with new Set Values
- Sharpen/Remesh improve mesh editing
- Crop meshes visually with Mouse Drag
- Colorize provides insight to meshes
- New Curve Fit creates better splines
- More UX improvements for usability
- Save Center and End Points options
- Stay current with improved Installer
- Surface Analyze speeds analysis
- Sort helps optimize CMM inspections
- Amazing new 2-Point Measure

Get more info at www.verisurf.com

- Verisurf 2017 Release Notes
- Verisurf 2017 FAQs
- [Verisurf YouTube channel](#)
- Verisurf Reference Guides



Verisurf 2017 boosts productivity as well as usability by empowering users with broad *new* functionality and substantial improvements to existing capabilities. The 2017 release showcases major productivity enhancements that will appeal to current QA professionals and empower new classes of users, specifically CAD operators and software application developers, to achieve levels of productivity not previously possible.

Modernized User Experience Makeover Enhances Productivity

The Verisurf 2017 user interface now follows the familiar *Microsoft Ribbon Framework* for consistent user interaction with Verisurf’s most commonly used functions. All new icons, customizable Ribbon Bars, Tabs, Groups, Panels, Galleries, Tech Tips, and redesigned dialogs

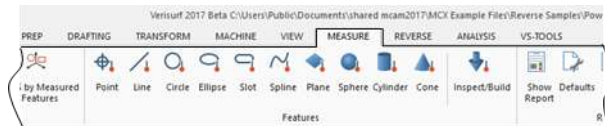

Partial updated MEASURE bar showing new icons

allow users to streamline and simplify the interface with application-specific configurations. Together, these improvements enhance the efficiency of experienced users and reduce time-to-productivity for learners..

SDK Opens New Pathways to Verisurf Customization

Verisurf 2017 features the premier of our new *Software Developer’s Kit* – or SDK. The SDK empowers manufacturers to harness the *full power of Verisurf* in creating their own metrology applications – an ideal tool set for streamlining simple, repetitive inspections or automating complex manufacturing processes.

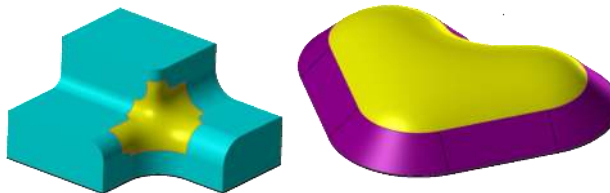

Power Surface Advances the Art of CAD Modelling and Reverse Engineering

Verisurf Reverse has been expanded with multiple new functions, most notably the amazing new *Power Surface*. Power Surface is a highly advanced CAD

surfacing tool that creates complex surfaces from measured points, point clouds, meshes and curves. It includes multiple, settable parameters - giving precise control over fit and tangency at boundaries.

New Scan Settings Assure Quality Results Faster

Measure Settings and *Measure Options* have been improved to simplify the measurement process and to enhance the performance of Verisurf when used in conjunction with laser scanners.

Scan rates can be configured separately for point-cloud measurement and surface inspection, and a maximum scan incidence angle can be specified to prevent loss of accuracy on highly curved surfaces. New *Color Scan* and *Remove Overlap* filter options help assess scan quality and reduce unwanted noise.

AutoAlign Gets Even Easier

Verisurf now approximates the location of the measuring device after one or two targets are measured. This is very useful in obtaining a rough alignment on CMMs prior to running AUTOMATE inspection plans.

AutoAlign targets can now be measured out-of-sequence following the third measurement - thus simplifying alignments that involve numerous targets. We’ve also added the ability to add material thickness (offset) to surface targets - a useful tool for performing in-process measurement checks when there is still an excess of material on the part.

Reverse Colorize Provides Visual Insight to Mesh Characteristics

Quickly generate gorgeous, extended spectrum fringe plots from meshes based on *Quality* (scan angle), *Z-height*, *Gaussian Curvature*, *Mean Curvature*, or *Thickness*.

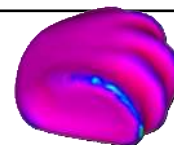

Colorize
based on scan angle

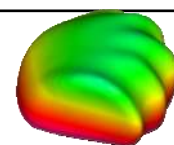

Colorize
based on Z-height

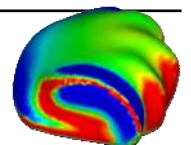

Colorize
based on wall thickness

Enforce Averaged or Nominal Values During Reverse Engineering with New *Set Values* Feature

Reverse: *Set Values* enables modification of position, size, shape, and orientation when applied to measured geometric points, point clouds, or features. Optionally - create copies to retain original (measured) values.

More Mesh Editing Control with *Sharpen* and *Remesh*

Mesh editing has been improved with the addition of a *Sharpen* command to refine the detail of a selected region. A new *Remesh* command creates the smoothest possible mesh for use after filtering or editing.

Crop Meshes Visually with *Mouse Drag*

Use your mouse to drag bounding box arrows for quick mesh cropping:

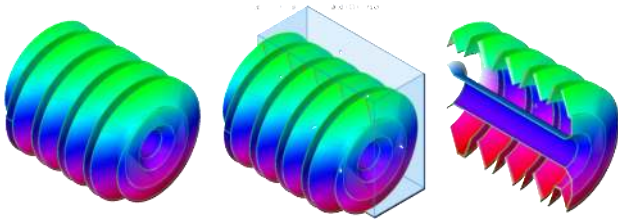

Fit Smooth Splines Fast and Accurately with *Curve Fit*

Creating smooth splines through measured points is easy with the new *Curve Fit* tool – now part of Verisurf Reverse. Ideal for filtering out noise in measured splines and creating smooth splines from the line segments saved when slicing or cropping meshes.



Even More UI Improvements

The *Measure Settings* dialog now docks automatically with the Measure Manager upon opening.

Measure Options has been moved to *Verisurf Preferences* for consistency and includes a convenient option to fit the screen to objects *automatically* as they are measured. In addition, the *Auto Center* and *Auto Set View* tools have been improved with smoother rendering, and new options have been added to display the *Diameter of Circular Features* and the *Length of Lines*.

Analysis/Build settings have been further streamlined for greater clarity to support improved workflow.

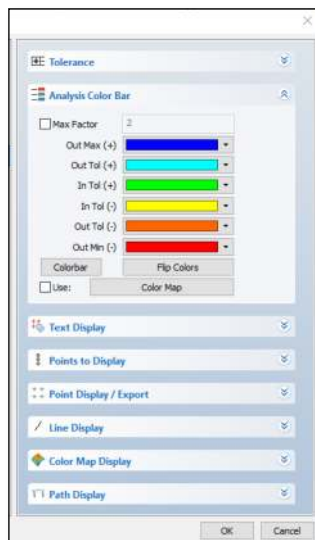

Reorganized Analysis/Build Dialog

Save Steps with *Save Center and End Points*

We've added an option to save the *Center* and *End Points* during the measurement of selected features to help automate the construction of these points with fewer steps.

New Integrated Installer

The new Verisurf 2017 installer checks for and installs Mastercam if necessary and automatically notifies the user of available software updates.

In addition, a new *Verisurf Updater* utility makes it easy to quickly ensure that you're using the most up-to-date version of Verisurf.

Optimize Automate Inspection Plans with New *Sort*

Plans in Automate now include a speed menu option to *Sort* Items by Name, by Distance from a selected feature, by feature size, or in reverse order.

Amazing 2-Point Measure

No more constructing sets of planes to measure 2D distances. Verisurf's new *2-point Measure* functionality lets you measure length, width, height, step, flush, or gap on any set of parallel surfaces with *only 2 probe touches!* The displayed results show dimension type, measured value, and nominal value - providing a quick way to get a nominal dimension without dimensional annotations or additional computations from a separate paper drawing.



X	0.2214
Y	-4.1150
Z	-0.0006
Analysis: "Inspect3"	
Dimension: Step	
D1: -0.0045 D2: 0.0024	
Measured: 0.3819 Nominal: 0.3750	
Deviation: 0.0069	

Contact your local Verisurf technical representative now to learn more about how you can reduce metrology operations cycle time with the Verisurf portfolio of advanced computer-aided inspection tools

sales@verisurf.com

toll-free: 888.713.7201